



LED WATTAGE CHART

Drive Current	16L
425 milliamps	22W (1208-2147 Lumens)
530 milliamps	28W (1829-3251 Lumens)
700 milliamps	37W (2415-4294 Lumens)
850 milliamps	43W (2933-5214 Lumens)

FORM

- Elegant Die-Cast Aluminum Housing
- Corrosion Resistant Stainless Steel External Hardware
- Sleek, Low Profile Housing
- Spec Grade Performance
- Engineered For Optimum Thermal Management

FUNCTION

- Micro Optics Distributions: 15°, 30°, 55°, 85°, T2, T3, T4, T5, T4FTW, T5W
- 0-10V Dimming Drivers
THD @ Max Load < 15%
Power factor @ Max Load < 0.95
- Amber, 2700K, 3000K, 3500K, 4000K, or 5000K
- 16L LED Configuration
- CRI 70, 80, or 90
- 5 Mils Powder Coat
- Up to 5,214 Lumens

RELIABILITY

- Silicone Micro Optics
- 5 Year Standard Warranty
- IP67 Optics
- IP66 Fixture

BUY AMERICAN

To ensure the latest BAA/TAA/BABA Standards are being met, please select BAA, TAA, or BABA in the options section. Please contact the factory before placing an order for any NLS products requesting BAA (Buy American Act), TAA (Trade Agreement Act), or BABA (Build America, Buy America).



Project Name:

Type:

ORGANIX - 1 PENDANT MOUNT ORDERING GUIDE

Cat#	Light Dist.	# of LEDs	Miliamps	Kelvin	Volts
Organix - 1 Ceiling Mount (ORX-1)	15° Very Narrow Beam (15) ¹⁶	16 (16L)	425 (42)	Amber 585-600nm (AMBER) ^{2, 4, 7, 10}	120-277 (UNV)
	30° Narrow Beam (30)		530 (53)	Amber LED Phosphor Converted (AMBER/PC) ^{2, 7, 10}	
	55° Medium Beam (55)		700 (7)	2700K, 70 CRI (27K7) ⁷	
	85° Wide Beam (85)		850 (85) ¹³	2700K, 80 CRI (27K8) ^{1, 7}	
	Type 2 (T2)			3000K, 70 CRI (30K7) ⁷	
	Type 3 (T3)			3000K, 80 CRI (30K8) ^{1, 7}	
	Type 3 Medium (T3M)			3500K, 80 CRI (35K8)	
	Type 4 (T4)			4000K, 70 CRI (40K7)	
	Type 4 Forward Throw Wide (T4FTW)			4000K, 80 CRI (40K8) ¹	
	Type 5 (T5)			5000K, 70 CRI (50K7)	
	Type 5 Wide (T5W)			5000K, 80 CRI (50K8) ¹	

Mounting	Color	Controls Options	Options	Lens Options
Pendant Mount 12" Length (PM12)	Bronze Textured (BRZ)	Microwave Motion Sensor (MMS) ^{6, 9, 15}	Marine Grade Finish (MGF)	Clear Tempered Glass Lens (CTG) ¹⁴
Pendant Mount 24" Length (PM24)	White Textured (WHT)	Microwave Motion Sensor Custom Setting (MMS-CST) ^{2, 6, 15}	House Side Shield (HSS) ⁸	Diffused Polycarbonate Visual Comfort Lens (DPCL) ^{2, 14}
Pendant Mount 36" Length (PM36)	Smooth White Gloss (SWT)	Emergency Battery 4W (EM4) ⁶	Tamper Proof Hardware (TPH)	HAL Lens (HAL) ^{2, 11, 14}
Pendant Mount Custom Length (PMX) ¹²	Silver Metallic (SVR)	Custom Controls Integration (CCI) ³	Bird Shroud (BSC) ²	
	Black Textured (BLK)		Buy American Act (BAA) ⁵	
	Smooth Black Gloss (SBK)		Trade Agreement Act (TAA) ⁵	
	Graphite Textured (GPH)		Build America Buy American (BABA) ⁵	
	Grey Textured (GRY)			
	Green Textured (GRN)			
	Hunter Green Textured (HGN)			
	Custom (CS)			

NOTES:

- Consult Factory For Lead Time. Consult Factory For 90 CRI Requests.
- Consult Factory
- Please contact Factory for Custom Control Integration requests (nLight, NX, WaveLinx, Crestron, DMX/RDM, Synapse, Casambi, Dali II, Avi-On, or other control systems)
- Turtle Safe
- Consult factory for all BAA/TAA/BABA requests
- MMS and EM4 are not available in the same fixture
- 3000K or lower, with fixed mounting options only, must be selected to meet International Dark-Sky Association certification.
- Not Available with Lens Options (VCA, VCS, DPCL, CTG)
- MMS Setting - Occupancy: 100% Light Output.
After 30 Min No Occupancy: 10% Light Output.
For custom sensor settings, Please enter MMS-CST and Contact factory.
- Not Available above 530mA.
- HAL Lens: Yellow Polycarbonate Lens - less than 2% Blue Light Content
- Consult Factory for Custom Pendant Lengths.
- Not Available with Lens Options
- 700mA Max For Lens Options
- Only available with PM mounting option. Consult factory on other mounting options.
- 15° option is not available with any lens options



701 Kingshill Place, Carson, CA 90746
Call Us Today (310) 341-2037

nlsighting.com

PRODUCT SPECIFICATIONS

ELECTRICAL

- 120-277 Volts (UNV)
- 0-10V dimming driver
- Driver power factor at maximum load is $\geq .95$, THD maximum load is 15%
- LED Drivers Ambient Temp. Min is -40°C and Ambient Temp. Max ranges from 50°C to 55°C and, in some cases, even higher. Consult the factory for revalidation by providing the fixture catalog string before quoting and specifying it.
- All drivers, controls, and sensors housed in enclosed IP66 compartment
- CRI 70, 80 or 90
- Color temperatures: Amber, 2700K, 3000K, 3500K, 4000K, 5000K
- Surge Protection: 20KVA supplied as standard.

CONSTRUCTION

- Die Cast Aluminum
- Internal cooling fins
- Corrosion resistant external hardware
- One-piece silicone gasket ensures IP66 seal for electronics compartment

OPTICS

Silicone optics high thermal stability and light output provide higher powered LEDs with minimized lumen depreciation. UV stability with scratch resistance increases exterior application durability. Silicone optics do not yellow, crack or brittle over time.

CONTROL OPTIONS

- Microwave Motion Sensor
- Emergency Battery 4W
- Controls Agnostic: Please contact factory for your preferred controls option. (nLight, NX, WaveLinx, Crestron, DMX/RDM, Synapse, Casambi, DALI II, Avi-On, or other control systems)

OPTIONS

- BIRD SPIKES (BS) - Offer an effective and humane deterrent for larger bird species and provide a cost-effective long-term solution to nuisance bird infestations and to protect your property.
- MARINE GRADE FINISH (MGF) - A multi-step process creating a protective finishing coat against harsh environments. Chemically washed in a 5-stage cleaning system. Pre-baked, Powder coated 3-5 mils of Zinc Rich Super Durable Polyester Primer. Oven Baked. Finished Powder Coating of Super Durable Polyester Powder Coat 3-5 mil thickness.
- House Side Shield (HSS) is designed for full property line cutoff.

FINISH

- 3-5 mils electrostatic powder coat.
- NLS Lighting standard high-quality finishes prevent corrosion, and protects against extreme environmental conditions.
- 10 Standard Finishes, Custom Finish and Marine Grade Finish Available

WARRANTY

- Five-year limited warranty for drivers and LEDs.
- Consult Factory for 7 or 10 year warranty

LISTINGS

- UL Listed in compliance with UL 1598, the Standard for Safety of Luminaires, including the applicable wet location requirements
- Compliant with UL 8750 LED driver design and test safety standards
- CSA C22.2 No. 250.0
- IP66 Rated Fixture
- IP67 Rated Optics
- IK10 Rated
- Dark Sky Certified, 3000K or lower, with fixed mounting options only, must be selected to meet International Dark-Sky Association certification.

BUY AMERICAN OPTION

While all of the NLS Lighting products listed in this document qualify for the Buy America(n) Act of 1933, we reserve the right to change our listings without notice.

The information provided above is for general informational purposes only. We encourage you to consult legal professionals for advice particular to your projects concerning BAA, TAA, BABA or Buy America.

Additional NLS Products that meet BAA, TAA standards can be found at the following link:

<https://nslighting.com/buy-american/>



The information and specifications on this document are subject to change without any notification. All values are design, nominal, typical or prorated values when measured under internal and external laboratory conditions.



701 Kingshill Place, Carson, CA 90746
Call Us Today (310) 341-2037

nslighting.com

PRODUCT SPECIFICATIONS

MODEL	WIDTH	HEIGHT	WEIGHT
ORX-1-PM	9.20"	2.37"	4 LBS

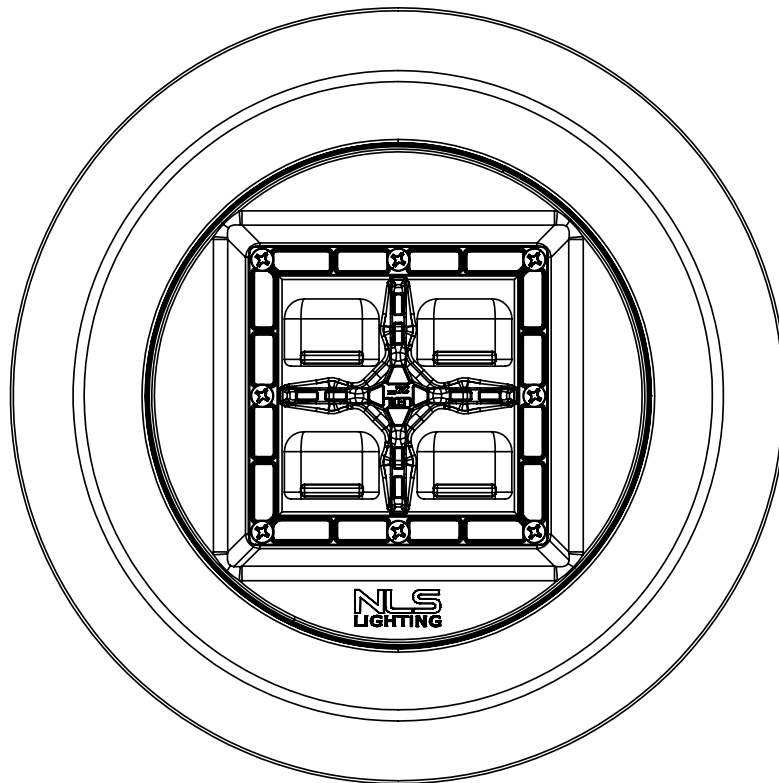
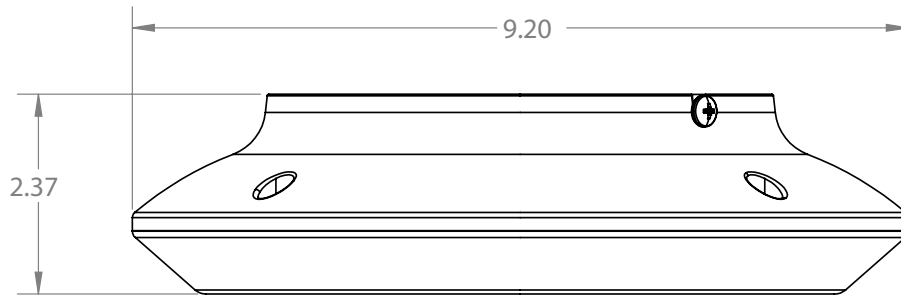

SCAN FOR INSTALLATION INSTRUCTIONS



NLS
LIGHTING

701 Kingshill Place, Carson, CA 90746
Call Us Today (310) 341-2037

nslighting.com

PRODUCT SPECIFICATIONS

LED KELVIN RANGE

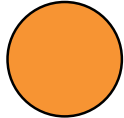

AMBER
585-600 nm

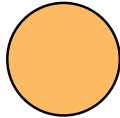

2700K 70 CRI

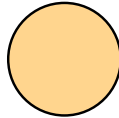

3000K 70 CRI

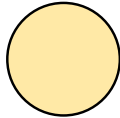

3500K 80 CRI

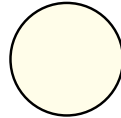

4000K 70 CRI

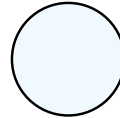

5000K 70 CRI

Color	Dominant or Peak Wavelength Range (nm)	
	Minimum	Maximum
Amber	585	600

Lumen Maintenance Data							
Ambient Temperature	Drive Current	L90 Hours*	L70 Hours**	30,000 Hours*	50,000 Hours*	60,000 Hours*	100,000 Hours**
25°C	Up to 700mA	58,000	173,000	95.7%	91.6%	89.6%	82.1%
	850mA	48,000	143,000	94.3%	89.5%	87.2%	78.5%
*Reported extrapolations per IESNA TM-21				**Projected extrapolations per IESNA TM-21			

LUMEN CHARTS

LUMEN CHART AMBER WITH T3					
PART NUMBER	T3	LPW	WATTAGE	BUG	MULTIPLIER FOR 50K7 GOING TO AMBER
ORX-1-PM-16L-42-AMBER	1049	58	18	B0-U0-G0	0.4211
ORX-1-PM-16L-53-AMBER	1256	55	23	B0-U0-G0	0.4043

LUMEN CHART AMBER WITH T2					
PART NUMBER	T2	LPW	WATTAGE	BUG	MULTIPLIER FOR 50K7 GOING TO AMBER
ORX-1-PM-16L-42-AMBER	1046	58	18	B0-U0-G0	0.4211
ORX-1-PM-16L-53-AMBER	1253	54	23	B0-U0-G0	0.4043

LUMEN CHART AMBER WITH T4FTW					
PART NUMBER	T4FTW	LPW	WATTAGE	BUG	MULTIPLIER FOR 50K7 GOING TO AMBER
ORX-1-PM-16L-42-AMBER	929	52	18	B0-U0-G1	0.4211
ORX-1-PM-16L-53-AMBER	1087	47	23	B0-U0-G1	0.4043

LUMEN CHART AMBER WITH T5W					
PART NUMBER	T5W	LPW	WATTAGE	BUG	MULTIPLIER FOR 50K7 GOING TO AMBER
ORX-1-PM-16L-42-AMBER	1269	71	18	B1-U0-G1	0.4211
ORX-1-PM-16L-53-AMBER	1641	71	23	B1-U0-G1	0.4043

PRODUCT SPECIFICATIONS

LUMEN CHARTS

LUMEN CHART - STANDARD SILICONE MICRO OPTICS																	
PART NUMBER	15°	LPW	30°	LPW	55°	LPW	85°	LPW	T2	LPW	T3	LPW	T4	LPW	T5	LPW	WATTAGE
ORX-1-PM-16L-42-27K7	1684	77	1704	77	1774	81	1837	83	2126	97	2133	97	2088	95	2232	101	22
ORX-1-PM-16L-42-27K8	1577	72	1596	73	1661	75	1720	78	1991	90	1997	91	1955	89	2090	95	22
ORX-1-PM-16L-42-30K7	1821	83	1842	84	1918	87	1986	90	2135	97	2306	105	2258	103	2413	110	22
ORX-1-PM-16L-42-30K8	1690	77	1711	78	1781	81	1844	84	1983	90	2142	97	2097	95	2241	102	22
ORX-1-PM-16L-42-35K8	1690	77	1711	78	1781	81	1844	84	1983	90	2142	97	2097	95	2241	102	22
ORX-1-PM-16L-42-40K7	1967	89	1991	90	2072	94	2146	98	2484	113	2492	113	2440	111	2607	119	22
ORX-1-PM-16L-42-40K8	1821	83	1842	84	1918	87	1986	90	2299	105	2307	105	2259	103	2413	110	22
ORX-1-PM-16L-42-50K7	1967	89	1991	90	2072	94	2146	98	2484	113	2492	113	2440	111	2607	119	22
ORX-1-PM-16L-42-50K8	1821	83	1842	84	1918	87	1986	90	2299	105	2307	105	2259	103	2413	110	22
ORX-1-PM-16L-53-27K7	2100	75	2125	76	2212	79	2291	82	2652	95	2660	95	2604	93	2783	99	28
ORX-1-PM-16L-53-27K8	1966	70	1990	71	2071	74	2145	77	2483	89	2491	89	2439	87	2606	93	28
ORX-1-PM-16L-53-30K7	2270	81	2298	82	2392	85	2477	88	2867	102	2876	103	2816	101	3009	107	28
ORX-1-PM-16L-53-30K8	2108	75	2133	76	2221	79	2300	82	2663	95	2671	95	2615	93	2794	100	28
ORX-1-PM-16L-53-35K8	2108	75	2133	76	2221	79	2300	82	2663	95	2671	95	2615	93	2794	100	28
ORX-1-PM-16L-53-40K7	2453	88	2483	89	2584	92	2676	96	3098	111	3107	111	3042	109	3251	116	28
ORX-1-PM-16L-53-40K8	2270	81	2298	82	2392	85	2477	88	2868	102	2876	103	2816	101	3009	107	28
ORX-1-PM-16L-53-50K7	2453	88	2483	89	2584	92	2676	96	3098	111	3107	111	3042	109	3251	116	28
ORX-1-PM-16L-53-50K8	2270	81	2298	82	2392	85	2477	88	2868	102	2876	103	2816	101	3009	107	28
ORX-1-PM-16L-70-27K7	2773	75	2807	76	2922	79	3026	82	3502	95	3513	95	3439	93	3676	99	37
ORX-1-PM-16L-70-27K8	2597	70	2628	71	2736	74	2833	77	3279	89	3290	89	3220	87	3442	93	37
ORX-1-PM-16L-70-30K7	2999	81	3035	82	3159	85	3271	88	3786	102	3798	103	3719	101	3974	107	37
ORX-1-PM-16L-70-30K8	2784	75	2818	76	2933	79	3037	82	3516	95	3527	95	3454	93	3691	100	37
ORX-1-PM-16L-70-35K8	2784	75	2818	76	2933	79	3037	82	3516	95	3527	95	3454	93	3691	100	37
ORX-1-PM-16L-70-40K7	3240	88	3279	89	3413	92	3535	96	4091	111	4104	111	4018	109	4294	116	37
ORX-1-PM-16L-70-40K8	2999	81	3035	82	3159	85	3271	88	3787	102	3799	103	3719	101	3975	107	37
ORX-1-PM-16L-70-50K7	3240	88	3279	89	3413	92	3535	96	4091	111	4104	111	4018	109	4294	116	37
ORX-1-PM-16L-70-50K8	2999	81	3035	82	3159	85	3271	88	3787	102	3799	103	3719	101	3975	107	37
ORX-1-PM-16L-85-27K7	3764	88	3809	89	3965	92	4106	95	4253	99	4265	99	4176	97	4463	104	43
ORX-1-PM-16L-85-27K8	3524	82	3567	83	3713	86	3845	89	3983	93	3994	93	3911	91	4179	97	43
ORX-1-PM-16L-85-30K7	4069	95	4118	96	4287	100	4440	103	4598	107	4612	107	4516	105	4826	112	43
ORX-1-PM-16L-85-30K8	3778	88	3824	89	3980	93	4122	96	4270	99	4283	100	4194	98	4482	104	43
ORX-1-PM-16L-85-35K8	3778	88	3824	89	3980	93	4122	96	4270	99	4283	100	4194	98	4482	104	43
ORX-1-PM-16L-85-40K7	4397	102	4450	103	4632	108	4797	112	4968	116	4983	116	4879	113	5214	121	43
ORX-1-PM-16L-85-40K8	4069	95	4118	96	4287	100	4440	103	4598	107	4612	107	4516	105	4826	112	43
ORX-1-PM-16L-85-50K7	4397	102	4450	103	4632	108	4797	112	4968	116	4983	116	4879	113	5214	121	43
ORX-1-PM-16L-85-50K8	4069	95	4118	96	4287	100	4440	103	4598	107	4612	107	4516	105	4826	112	43

3000K or lower, with fixed mounting options only, must be selected to meet International Dark Sky Association Certification

PRODUCT SPECIFICATIONS

LUMEN CHART - PERFORMANCE SILICONE MICRO OPTICS													
PART NUMBER	T3M	LM/W	T3M CLEAR LENS	LM/W	T4FTW	LPW	T4FTW CTG	LPW	T5W	LPW	T5W CTG	LPW	WATTAGE
ORX-1-PM-16L-42-27K7	2421	110	2058	94	2523	115	1989	90	2580	117	2034	92	22
ORX-1-PM-16L-42-27K8	2257	103	1918	87	2363	107	1863	85	2416	110	1905	87	22
ORX-1-PM-16L-42-30K7	2810	128	2388	109	2041	93	1609	73	2789	127	2199	100	22
ORX-1-PM-16L-42-30K8	2435	111	2070	94	1895	86	1494	68	2590	118	2042	93	22
ORX-1-PM-16L-42-35K8	2444	111	2077	94	1895	86	1494	68	2590	118	2042	93	22
ORX-1-PM-16L-42-40K7	2882	131	2450	111	2205	100	1738	79	3014	137	2376	108	22
ORX-1-PM-16L-42-40K8	2594	118	2205	100	2041	93	1609	73	2790	127	2199	100	22
ORX-1-PM-16L-42-50K7	2882	131	2450	111	2205	100	1738	79	3014	137	2376	108	22
ORX-1-PM-16L-42-50K8	2594	118	2205	100	2041	93	1609	73	2790	127	2199	100	22
ORX-1-PM-16L-53-27K7	2869	102	2439	87	2301	82	1841	66	3475	124	2780	99	28
ORX-1-PM-16L-53-27K8	2675	96	2274	81	2155	77	1724	62	3254	116	2603	93	28
ORX-1-PM-16L-53-30K7	3331	119	2831	101	2488	89	1990	71	3758	134	3006	107	28
ORX-1-PM-16L-53-30K8	2887	103	2454	88	2311	83	1848	66	3490	125	2792	100	28
ORX-1-PM-16L-53-35K8	2897	103	2462	88	2311	83	1848	66	3490	125	2792	100	28
ORX-1-PM-16L-53-40K7	3416	122	2904	104	2688	96	2150	77	4060	145	3248	116	28
ORX-1-PM-16L-53-40K8	3074	110	2613	93	2488	89	1990	71	3758	134	3006	107	28
ORX-1-PM-16L-53-50K7	3416	122	2904	104	2688	96	2150	77	4060	145	3248	116	28
ORX-1-PM-16L-53-50K8	3074	110	2613	93	2488	89	1990	71	3758	134	3006	107	28
ORX-1-PM-16L-7-27K7	3481	94	2959	80	2681	72	2138	58	4529	122	3611	98	37
ORX-1-PM-16L-7-27K8	3245	88	2758	75	2511	68	2002	54	4241	115	3382	91	37
ORX-1-PM-16L-7-30K7	4040	109	3434	93	2899	78	2311	62	4897	132	3904	106	37
ORX-1-PM-16L-7-30K8	3502	95	2976	80	2692	73	2146	58	4548	123	3626	98	37
ORX-1-PM-16L-7-35K8	3514	95	2987	81	2692	73	2146	58	4548	123	3626	98	37
ORX-1-PM-16L-7-40K7	4144	112	3522	95	3132	85	2497	67	5291	143	4218	114	37
ORX-1-PM-16L-7-40K8	3730	101	3170	86	2899	78	2311	62	4897	132	3904	106	37
ORX-1-PM-16L-7-50K7	4144	112	3522	95	3132	85	2497	67	5291	143	4218	114	37
ORX-1-PM-16L-7-50K8	3730	101	3170	86	2899	78	2311	62	4897	132	3904	106	37
ORX-1-PM-16L-85-27K7	3918	93	3330	79	4058	97	3241	77	4587	109	3664	87	42
ORX-1-PM-16L-85-27K8	3652	87	3104	74	3800	90	3035	72	4295	102	3431	82	42
ORX-1-PM-16L-85-30K7	4547	108	3865	92	4388	104	3504	83	4960	118	3961	94	42
ORX-1-PM-16L-85-30K8	3941	94	3350	80	4075	97	3254	77	4606	110	3678	88	42
ORX-1-PM-16L-85-35K8	3955	94	3362	80	4075	97	3254	77	4606	110	3678	88	42
ORX-1-PM-16L-85-40K7	4664	111	3964	94	4741	113	3786	90	5359	128	4280	102	42
ORX-1-PM-16L-85-40K8	4198	100	3568	85	4388	104	3505	83	4960	118	3962	94	42
ORX-1-PM-16L-85-50K7	4664	111	3964	94	4741	113	3786	90	5359	128	4280	102	42
ORX-1-PM-16L-85-50K8	4198	100	3568	85	4388	104	3505	83	4960	118	3962	94	42

3000K or lower, with fixed mounting options only, must be selected to meet International Dark Sky Association Certification

PRODUCT SPECIFICATIONS

BUG RATING CHARTS

BUG RATING CHART - STANDARD SILICONE MICRO OPTICS				
PART NUMBER	T2	T3	T4	T5
ORX-1-PM-16L-40-27K7	B1-U0-B1	B1-U0-B1	B1-U0-B1	B2-U0-B1
ORX-1-PM-16L-40-27K8	B1-U0-B1	B1-U0-B1	B1-U0-B1	B2-U0-B1
ORX-1-PM-16L-40-30K7	B1-U0-B1	B1-U0-B1	B1-U0-B1	B2-U0-B1
ORX-1-PM-16L-40-30K8	B1-U0-B1	B1-U0-B1	B1-U0-B1	B2-U0-B1
ORX-1-PM-16L-40-35K8	B1-U0-B1	B1-U0-B1	B1-U0-B1	B2-U0-B1
ORX-1-PM-16L-40-40K7	B1-U0-B1	B1-U0-B1	B1-U0-B1	B2-U0-B1
ORX-1-PM-16L-40-40K8	B1-U0-B1	B1-U0-B1	B1-U0-B1	B2-U0-B1
ORX-1-PM-16L-40-50K7	B1-U0-B1	B1-U0-B1	B1-U0-B1	B2-U0-B1
ORX-1-PM-16L-40-50K8	B1-U0-B1	B1-U0-B1	B1-U0-B1	B2-U0-B1
ORX-1-PM-16L-53-27K7	B1-U0-B1	B1-U0-B1	B1-U0-B1	B2-U0-B1
ORX-1-PM-16L-53-27K8	B1-U0-B1	B1-U0-B1	B1-U0-B1	B2-U0-B1
ORX-1-PM-16L-53-30K7	B1-U0-B1	B1-U0-B1	B1-U0-B1	B2-U0-B1
ORX-1-PM-16L-53-30K8	B1-U0-B1	B1-U0-B1	B1-U0-B1	B2-U0-B1
ORX-1-PM-16L-53-35K8	B1-U0-B1	B1-U0-B1	B1-U0-B1	B2-U0-B1
ORX-1-PM-16L-53-40K7	B1-U0-B1	B1-U0-B1	B1-U0-B1	B2-U0-B1
ORX-1-PM-16L-53-40K8	B1-U0-B1	B1-U0-B1	B1-U0-B1	B2-U0-B1
ORX-1-PM-16L-53-50K7	B1-U0-B1	B1-U0-B1	B1-U0-B1	B2-U0-B1
ORX-1-PM-16L-53-50K8	B1-U0-B1	B1-U0-B1	B1-U0-B1	B2-U0-B1
ORX-1-PM-16L-70-27K7	B1-U0-B1	B1-U0-B1	B1-U0-B1	B2-U0-B1
ORX-1-PM-16L-70-27K8	B1-U0-B1	B1-U0-B1	B1-U0-B1	B2-U0-B1
ORX-1-PM-16L-70-30K7	B1-U0-B1	B1-U0-B1	B1-U0-B1	B2-U0-B1
ORX-1-PM-16L-70-30K8	B1-U0-B1	B1-U0-B1	B1-U0-B1	B2-U0-B1
ORX-1-PM-16L-70-35K8	B1-U0-B1	B1-U0-B1	B1-U0-B1	B2-U0-B1
ORX-1-PM-16L-70-40K7	B1-U0-B1	B1-U0-B1	B1-U0-B1	B3-U0-B1
ORX-1-PM-16L-70-40K8	B1-U0-B1	B1-U0-B1	B1-U0-B1	B3-U0-B1
ORX-1-PM-16L-70-50K7	B1-U0-B1	B1-U0-B1	B1-U0-B1	B3-U0-B1
ORX-1-PM-16L-70-50K8	B1-U0-B1	B1-U0-B1	B1-U0-B1	B3-U0-B1
ORX-1-PM-16L-85-27K7	B1-U0-B1	B1-U0-B1	B1-U0-B1	B3-U0-B1
ORX-1-PM-16L-85-27K8	B1-U0-B1	B1-U0-B1	B1-U0-B1	B3-U0-B1
ORX-1-PM-16L-85-30K7	B1-U0-B1	B1-U0-B1	B1-U0-B1	B3-U0-B1
ORX-1-PM-16L-85-30K8	B1-U0-B1	B1-U0-B1	B1-U0-B1	B3-U0-B1
ORX-1-PM-16L-85-35K8	B1-U0-B1	B1-U0-B1	B1-U0-B1	B3-U0-B1
ORX-1-PM-16L-85-40K7	B1-U0-B1	B1-U0-B1	B1-U0-B1	B3-U0-B1
ORX-1-PM-16L-85-40K8	B1-U0-B1	B1-U0-B1	B1-U0-B1	B3-U0-B1
ORX-1-PM-16L-85-50K7	B1-U0-B1	B1-U0-B1	B1-U0-B1	B3-U0-B1
ORX-1-PM-16L-85-50K8	B1-U0-B1	B1-U0-B1	B1-U0-B1	B3-U0-B1

PRODUCT SPECIFICATIONS

BUG RATING CHART - PERFORMANCE SILICONE MICRO OPTICS						
PART NUMBER	T3M	T3M CLEAR LENS	T4FTW	T4FTW CTG	T5W	T5W CTG
ORX-1-PM-16L-42-27K7	B1-U0-G1	B1-U0-G1	B1-U0-G1	B1-U0-G1	B2-U0-G1	B1-U0-G1
ORX-1-PM-16L-42-27K8	B1-U0-G1	B1-U0-G1	B1-U0-G1	B1-U0-G1	B2-U0-G1	B1-U0-G1
ORX-1-PM-16L-42-30K7	B1-U0-G2	B1-U0-G1	B1-U0-G1	B1-U0-G1	B2-U0-G1	B1-U0-G1
ORX-1-PM-16L-42-30K8	B1-U0-G1	B1-U0-G1	B1-U0-G1	B1-U0-G1	B2-U0-G1	B1-U0-G1
ORX-1-PM-16L-42-35K8	B1-U0-G1	B1-U0-G1	B1-U0-G1	B1-U0-G1	B2-U0-G1	B1-U0-G1
ORX-1-PM-16L-42-40K7	B1-U0-G2	B1-U0-G1	B1-U0-G1	B1-U0-G1	B2-U0-G1	B1-U0-G1
ORX-1-PM-16L-42-40K8	B1-U0-G2	B1-U0-G1	B1-U0-G1	B1-U0-G1	B2-U0-G1	B1-U0-G1
ORX-1-PM-16L-42-50K7	B1-U0-G2	B1-U0-G1	B1-U0-G1	B1-U0-G1	B2-U0-G1	B1-U0-G1
ORX-1-PM-16L-42-50K8	B1-U0-G2	B1-U0-G1	B1-U0-G1	B1-U0-G1	B2-U0-G1	B1-U0-G1
ORX-1-PM-16L-53-27K7	B1-U0-G2	B1-U0-G1	B1-U0-G1	B1-U0-G1	B3-U0-G1	B1-U0-G1
ORX-1-PM-16L-53-27K8	B1-U0-G2	B1-U0-G1	B1-U0-G1	B1-U0-G1	B3-U0-G1	B1-U0-G1
ORX-1-PM-16L-53-30K7	B1-U0-G2	B1-U0-G2	B1-U0-G1	B1-U0-G1	B3-U0-G1	B1-U0-G1
ORX-1-PM-16L-53-30K8	B1-U0-G2	B1-U0-G2	B1-U0-G1	B1-U0-G1	B3-U0-G1	B1-U0-G1
ORX-1-PM-16L-53-35K8	B1-U0-G2	B1-U0-G2	B1-U0-G1	B1-U0-G1	B3-U0-G1	B1-U0-G1
ORX-1-PM-16L-53-40K7	B1-U0-G2	B1-U0-G2	B1-U0-G1	B1-U0-G1	B3-U0-G1	B1-U0-G1
ORX-1-PM-16L-53-40K8	B1-U0-G2	B1-U0-G2	B1-U0-G1	B1-U0-G1	B3-U0-G1	B1-U0-G1
ORX-1-PM-16L-53-50K7	B1-U0-G2	B1-U0-G2	B1-U0-G1	B1-U0-G1	B3-U0-G1	B1-U0-G1
ORX-1-PM-16L-53-50K8	B1-U0-G2	B1-U0-G2	B1-U0-G1	B1-U0-G1	B3-U0-G1	B1-U0-G1
ORX-1-PM-16L-7-27K7	B1-U0-G2	B1-U0-G2	B1-U0-G1	B1-U0-G1	B3-U0-G1	B1-U0-G1
ORX-1-PM-16L-7-27K8	B1-U0-G2	B1-U0-G2	B1-U0-G1	B1-U0-G1	B3-U0-G1	B1-U0-G1
ORX-1-PM-16L-7-30K7	B1-U0-G2	B1-U0-G2	B1-U0-G1	B1-U0-G1	B3-U0-G2	B1-U0-G1
ORX-1-PM-16L-7-30K8	B1-U0-G2	B1-U0-G2	B1-U0-G1	B1-U0-G1	B3-U0-G2	B1-U0-G1
ORX-1-PM-16L-7-35K8	B1-U0-G2	B1-U0-G2	B1-U0-G1	B1-U0-G1	B3-U0-G2	B1-U0-G1
ORX-1-PM-16L-7-40K7	B1-U0-G2	B1-U0-G2	B1-U0-G2	B1-U0-G1	B3-U0-G2	B1-U0-G1
ORX-1-PM-16L-7-40K8	B1-U0-G2	B1-U0-G2	B1-U0-G2	B1-U0-G1	B3-U0-G2	B1-U0-G1
ORX-1-PM-16L-7-50K7	B1-U0-G2	B1-U0-G2	B1-U0-G2	B1-U0-G1	B3-U0-G2	B1-U0-G1
ORX-1-PM-16L-7-50K8	B1-U0-G2	B1-U0-G2	B1-U0-G2	B1-U0-G1	B3-U0-G2	B1-U0-G1
ORX-1-PM-16L-85-27K7	B1-U0-G2	B1-U0-G2	B1-U0-G2	B1-U0-G1	B3-U0-G1	B1-U0-G1
ORX-1-PM-16L-85-27K8	B1-U0-G2	B1-U0-G2	B1-U0-G2	B1-U0-G1	B3-U0-G1	B1-U0-G1
ORX-1-PM-16L-85-30K7	B1-U0-G2	B1-U0-G2	B1-U0-G2	B1-U0-G1	B3-U0-G1	B1-U0-G1
ORX-1-PM-16L-85-30K8	B1-U0-G2	B1-U0-G2	B1-U0-G2	B1-U0-G1	B3-U0-G1	B1-U0-G1
ORX-1-PM-16L-85-35K8	B1-U0-G2	B1-U0-G2	B1-U0-G2	B1-U0-G1	B3-U0-G1	B1-U0-G1
ORX-1-PM-16L-85-40K7	B1-U0-G2	B1-U0-G2	B1-U0-G2	B1-U0-G1	B3-U0-G2	B1-U0-G1
ORX-1-PM-16L-85-40K8	B1-U0-G2	B1-U0-G2	B1-U0-G2	B1-U0-G1	B3-U0-G2	B1-U0-G1
ORX-1-PM-16L-85-50K7	B1-U0-G2	B1-U0-G2	B1-U0-G2	B1-U0-G1	B3-U0-G2	B1-U0-G1
ORX-1-PM-16L-85-50K8	B1-U0-G2	B1-U0-G2	B1-U0-G2	B1-U0-G1	B3-U0-G2	B1-U0-G1

PRODUCT SPECIFICATIONS

MARINE GRADE FINISH (MGF)

The (MGF) is a multi step process. Chemically washed in a 5 stage cleaning system. Pre-baked. Powder coated 3-5 mil of Zinc Rich Super Durable Polyester Primer. Oven Baked.

Finished Powder Coating of Super Durable Polyester Powder Coat 3-5 mil thickness.

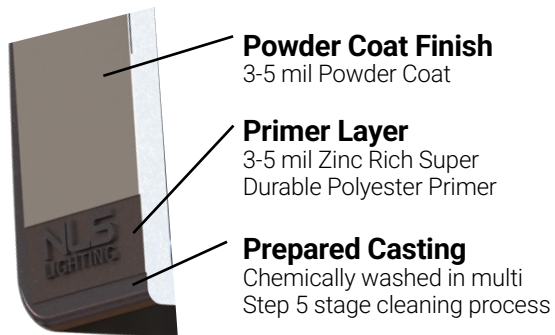

HOUSE SIDE SHIELD (HSS)

House Side Shield (HSS) is designed for stringent property line cutoff. Injection Molded Glass Filled Nylon, standard finish is black.

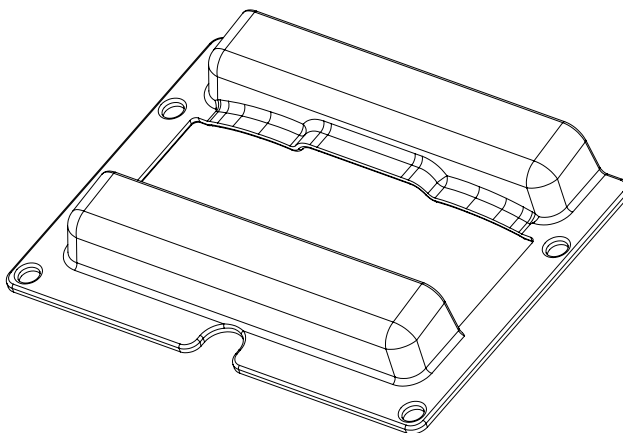

TAMPER PROOF HARDWARE

316 Stainless Steel Button Head Hex Drive Screws. Provided to protect the optical assembly and the driver compartment for vandal resistance.

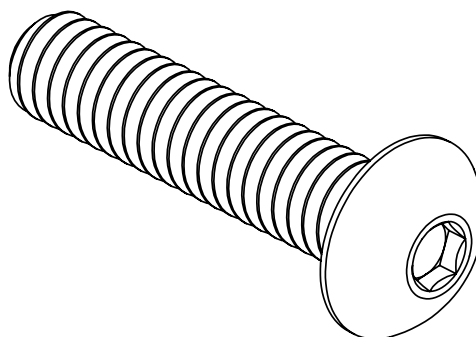

IES DISTRIBUTIONS

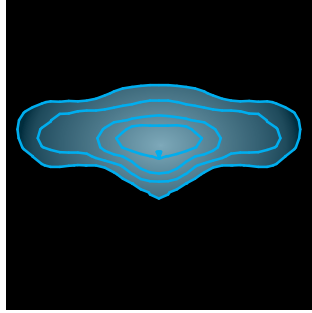
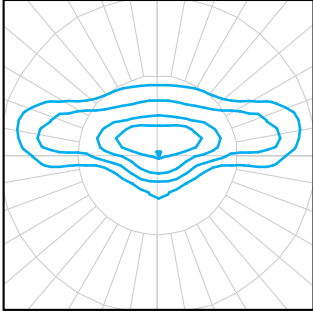

T2 OPTIC

The Type II distribution is used for narrow pathways and trails, narrow entrances of shopping centers, parking lots and office complex's.

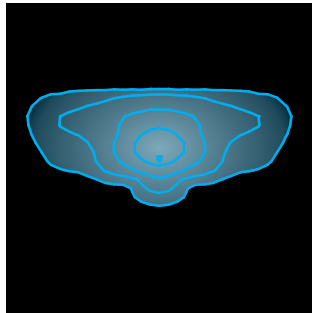
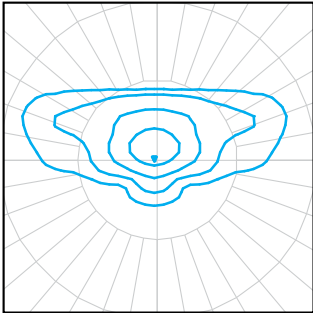

T3 OPTIC

The type III distribution is meant for roadway lighting, general parking areas and other areas where a larger area of lighting is required. Type III lighting needs to be placed to the side of the area, allowing the light to project outward and fill the area. This produces a filling light flow.

Type III light distributions have a preferred lateral width of 40 degrees. This distribution is intended for luminaires mounted at or near the side of medium width roadways or areas, where the width of the roadway or area does not exceed 2.75 times the mounting height.

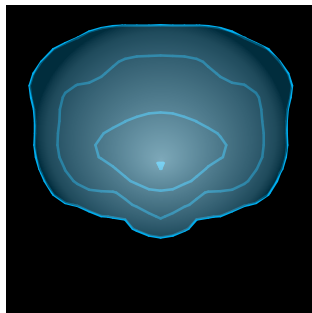
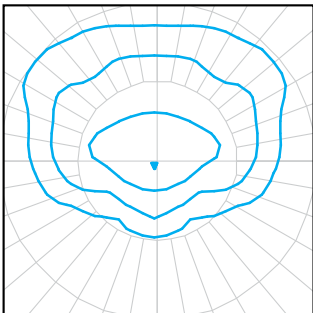

T4 OPTIC

The type IV distribution produces a semicircular light meant for mounting on the sides of buildings and walls. It's best for illuminating the perimeter of parking areas and businesses. The intensity of the Type IV lighting has the same intensity at angles from 90 degrees to 270 degrees.

Type IV light distributions have a preferred lateral width of 60 degrees. This distribution is intended for side-of-road mounting and is generally used on wide roadways where the roadway width does not exceed 3.7 times the mounting height.

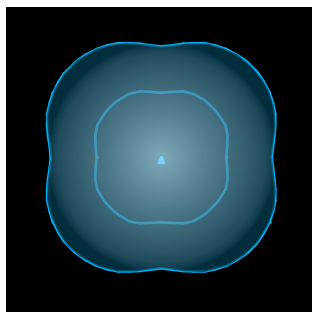
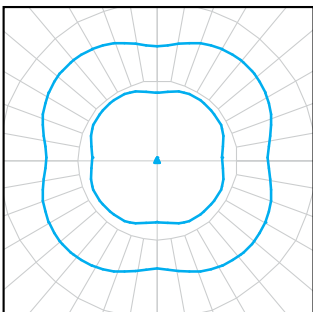

T5 OPTIC - SYMMETRICAL

Type V produces a symmetrical distribution that has the same intensity at all angles. This distribution has a uniform symmetry of candlepower that is essentially the same at all lateral angles. It is meant for large, commercial parking lot lighting as well as areas where sufficient, evenly distributed light is necessary.

SILICONE OPTICS

NLS Lighting Silicone Micro Optical System technology takes quality and performance to the highest level. Vandal resistant, superior clarity—Micro Optics have become the best and lasting solution in the industry.

BENEFITS

- Produces superior 96% clarity
- Heat resistant to 150° C, 50% higher than acrylic
- Ecologically friendly—no glare
- Vandal-resistant
- Does not brittle, crack, or yellow over time

