

ASA | ARCHITECTURAL SWEEP ARM

INSTALLATION INSTRUCTIONS

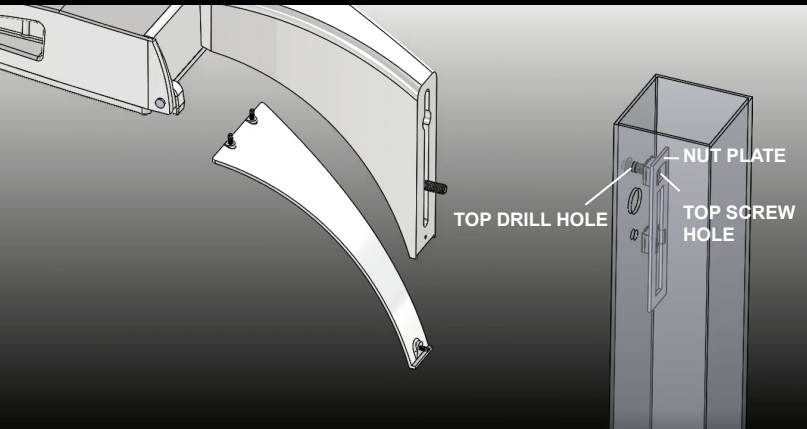

STEP 1 ▲

Take Nut Plate and align top screw hole with top drill hole on pole. Start top screw to temporarily hold Nut Plate in place.

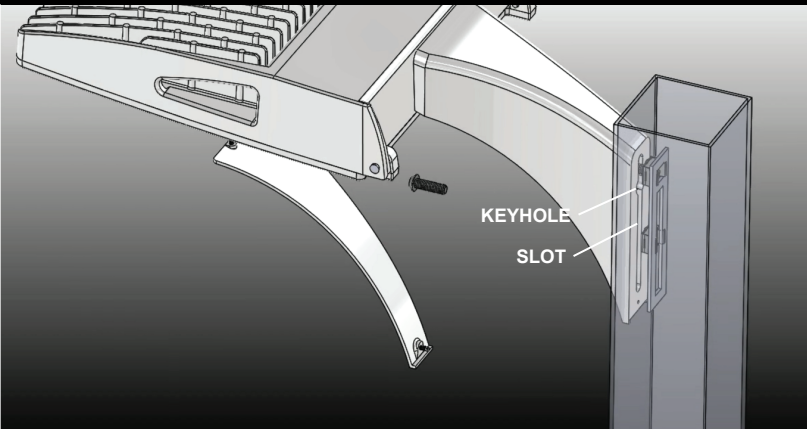

STEP 2 ▲

Attach the back of ASA to pole by inserting the Nut Plate screw-head through keyhole of slot, then slide downward until the ASA hooks properly.

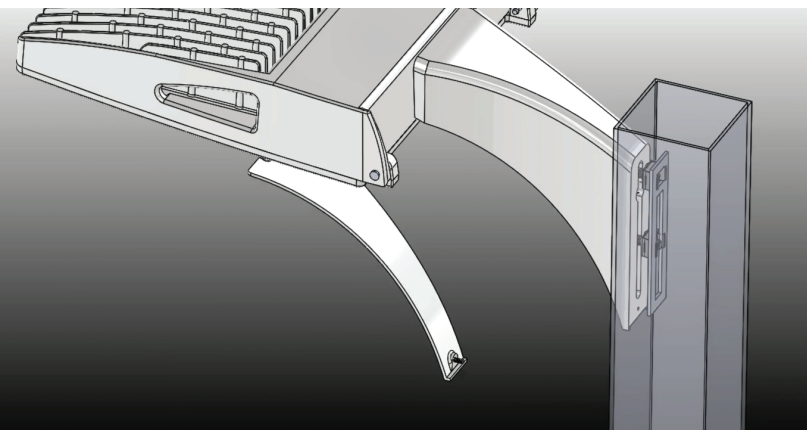

STEP 3 ▲

Fasten bottom screw of ASA through its slot onto pole. Secure both top and bottom bolts tightly.

***Fixture Must Be Level**

HIGHLIGHT:

Elongated slot on ASA is designed for universal pole mounting and will fit any existing drill pattern.

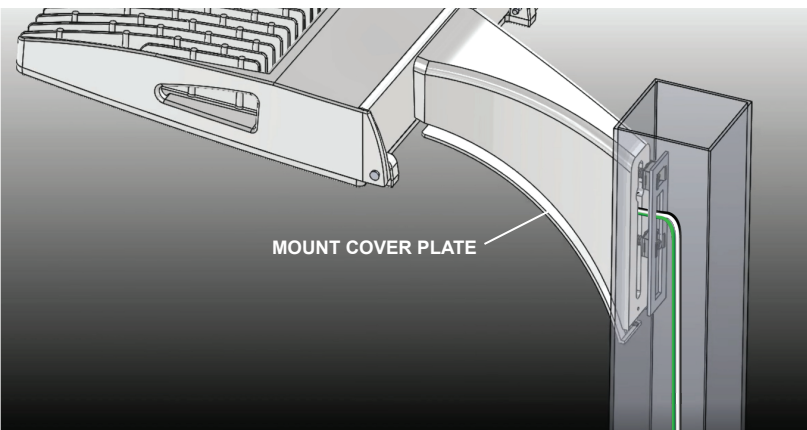

STEP 4 & 5 ▲

Feed pole wires through Nut Plate slot, pole Wireway and ASA slot. Using the provided wagos, finalize wire connection in ASA.

Tighten the outer screws on the Mount Cover Plate.

VIDEO LINK DEMO:

http://nlsighting.com/wp-content/uploads/cs/NLS_ASA_InstallationSteps.mp4