



A1 Single



A1 Double 180



A1 Wall Mount

Architectural Arm 1 is constructed of extruded aluminum tubing. Integrates with poles or tenons of 3-1/2", 4", 4-1/2", or 5" OD and is secured with 3/8" stainless steel Allen set screws.

Contact NLS for custom configuration or others mounting options. Arms are designed, tooled, fabricated and assembled in the USA.

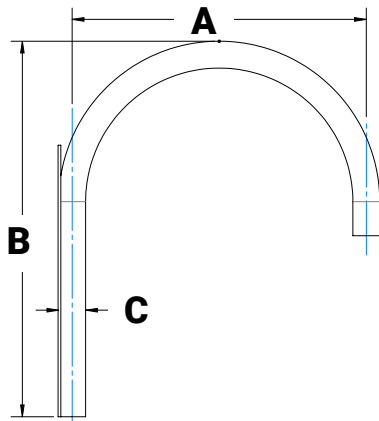

A1 Wall Mount

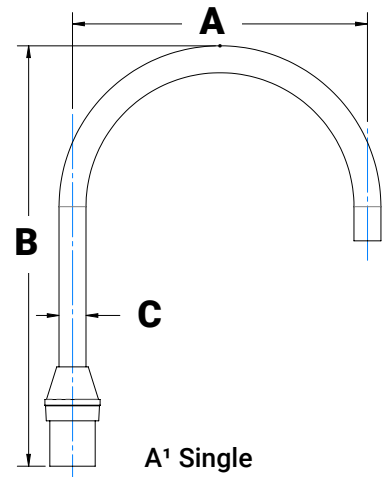
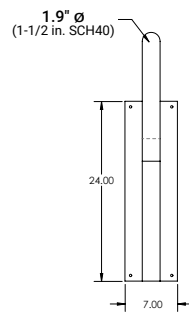

A1 Single

| MODEL | A | B | C | EPA SGL | EPA DBL | EPA WM |
|-------|--------|--------|-------------------------------|---------|---------|--------|
| A1-S | 17 in. | 20 in. | 1 7/8" Ø (1-1/2 in. SCH40) | 1.2 | 1.9 | 1.0 |
| A1-L | 26 in. | 38 in. | 1 7/8" Ø (1-1/2 in. SCH40) | 1.5 | 2.7 | 1.0 |
| A1-XL | 26 in. | 38 in. | 2 3/8" Ø (2 in. SCH40) | 1.8 | 3.0 | 1.2 |

| MODEL | STEEL | ALUMINUM |
|-------|----------|-----------|
| A1-S | 6.12 lbs | 17.83 lbs |
| A1-L | | |
| A1-XL | | |



Project Name:

Type:

ARCHITECTURAL ARM 1 ORDERING GUIDE

| Cat# | Mounting | Pole Diameter | Color |
|---|------------------------------|----------------------------------|---------------------------------------|
| Architectural Arm 1 Small (A1-S) | Single (SGL) | 3" Round OD (3R) | Bronze Textured (BRZ) |
| Architectural Arm 1 Large (A1-L) | Double 180° (D180) | 4" Round OD (4R) | White Textured (WHT) |
| Architectural Arm 1 X-Large (A1-XL) | Wall Mount (WM) | 4-1/2" Round OD (412R) | Smooth White Gloss (SWT) |
| | | 5" Round OD (5R) | Silver Metallic (SVR) |
| | | | Black Textured (BLK) |
| | | | Smooth Black Gloss (SBK) |
| | | | Graphite Textured (GPH) |
| | | | Grey Textured (GRY) |
| | | | Green Textured (GRN) |
| | | | Hunter Green Textured (HGN) |
| | | | Custom (CS) |

Notes:



701 Kingshill Place, Carson, CA 90746
Call Us Today (310) 341-2037

nlsighting.com