Height

20' - 39'

Pole Shaft

The pole shaft material is a weldable grade hot rolled commercial quality steel tubing with a minimum yield of 55,000 psi. Conforms to ASTM A500 Grade B Standards. Poles have ground lug welded inside hand-hole opposite side of the hand-hole. Pole shaft is welded to base plate on top and bottom of base plate.

Base Plate

The Base Plate is manufactured from structural hot rolled steel that meets or exceeds a minimum yield strength of 36,000 psi, conforms the ASTM-A36 standards. Base Plate is 1" thick.

Anchor Bolts

All anchor bolts are hot dipped galvanized steel and come with two galvanized nuts and washers per bolt. Minimum yield strength 50,000 psi. Anchor bolts are not included for Custom Bolt Circle.

Base Cover

All base covers are fabricated two-piece 6063 aluminum and powder coated to match the pole. Square base cover comes standard, Round Base Cover optional.

Hand-Hole

A reinforced hand-hole is 12" on center from the base plate and is constructed of 3"x 5" rectangular steel tubing which is welded to pole shaft for added strength. The hand-hole covers are provided with internal bridge support and powder coated to match pole finish.

Pole Cap

All poles come with a removable polymer pole cap installed. All pole caps are black finish. Aluminum Pole Cap option is painted to match pole.

Finish

All poles are treated with shot blast media for a near white finish, power blasted with 100 psi prior to powder coat application. Electrostatically applied polyester powder coat with a 3 to 5 mil thickness for maximum adherence.

Marine Grade Finish

All poles are washed through a 5-stage cleaning system with a deionized rinse, a 3 to 5 mils zinc rich durable polyester primer powder coat, followed by a 3 to 5 mils super durable polyester powder coat finish.

Galvanized Finish

All poles are Hot Dipped Galvanized in a multi stage process. Galvanizing Specification, Zinc (Hot Dipped Galvanized) per ASTM A 123/A 123M - 02

Zinc coatings on threaded materials shall conform to specification A 153 /A 153M. The coating shall be continuous and reasonably smooth and uniform in thickness and in weight.

Galvanizing Adherence - The Zinc coating shall withstand handling consistent with the nature and thickness of the coating and normal use of the article without peeling or flaking.

Galvanized Under Powder

Galvanized Under Powder (GUP) adheres to above galvanized specification, and the second stage is a light sand blast on the outside of the pole, third stage is a 3-5 mils polyester powder coat finish for maximum adherence.

Vibration Dampener

The Vibration Dampener is factory installed. The Vibration Dampener consists of a rugged galvanized chain coated with heavy duty polyester tubing that is factory secured at the bottom 2-3rds of the pole and field secured by contractor at the base during installation.

Buy American

To ensure the latest BAA/TAA/BABA Standards are being met, please select BAA, TAA, or BABA in the options section. Please contact the factory before placing an order for any NLS products requesting BAA (Buy American Act), TAA (Trade American Act), or BABA (Build America, Buy America).

Project Name:

Type:

RTSP ORDERING GUIDE

Cat#

Height

Gauge

Base Pattern

Mounting

Round
Tapered
Steel Pole
(RTSP)

20' (20)
25' (25)
30' (30)
35' (35)
39' (39)

.120
Wall Thickness
(11G)

.180
Wall Thickness
(7G)

(22'-30')
12-3/4"
Bolt Circle
(12BC)

Custom
Bolt Circle
(CBC)
** Consult Factory*

Single
(SGL)

Double
(D-90)
(D-180)

Triple
(T-90)

Quad
(QD)

No Drill
(ND)
**Tenon Option*

Color

Bolts

Options

Tenon

2 3/8" Round (T2R)

3" Round (T3R)

Bronze Textured
(BRZ)

White Textured
(WHT)

Smooth White
Gloss
(SWT)

Silver
(SVR)

Green Textured
(GRN)

Hunter Green Textured
(HGN)

Black Textured
(BLK)

Smooth Black
Gloss
(SBK)

Graphite Textured
(GPH)

Grey Textured
(GRY)

Custom
(CS)

1" x 36"
(136)

Less Anchor
Bolts
(LAB)

GFI Kit
(GFI20A) ①
20 Amp
Weather Proof Receptacle

GFI
Provision Only
(PROV)

Galvanized
(GLV)

Round Base Cover
(RBC)
**Consult Factory for Pricing*

Galvanized
Under Powder
(GUP)

1/2" Coupling
(COUP)
** Specify Location*

Vibration Dampener
(VD)

Extra Hand Hole
(XHH)
** Specify Location*

Marine Grade Finish
(MGF)

UL Certified with label
(UL) ①

Aluminum Pole Cap
(APC) ②

Buy American
(BAA) ②

Trade American
(TAA) ②

Build America Buy American
(BABA) ②

Notes:

- ① Aluminum Pole Cap must be selected for UL Certified Pole Option
- ② Consult Factory
- ③ Standard weatherproof cover comes standard with option.
For lockable cover requests, please contact factory

NLS
LIGHTING

701 Kingshill Place, Carson, CA 90746
Call Us Today (310) 341-2037

nlsighting.com

Max. allowable EPA - RTSP poles (per AASHTO LRFDLTS-1)

Catalog Number	Shaft Length, ft	Wall thickness, in.	Shaft dia., in.	Base Plate, in.	Bolt Circle, in.	Bolts	80 mph	Max. wt. (lb)	90 mph	Max. wt. (lb)	100 mph	Max. wt. (lb)	110 mph	Max. wt. (lb)	115 mph	Max. wt. lb	120 mph	Max. wt., lb	130 mph	Max. wt., lb	140 mph	Max. wt., lb	150 mph	Max. wt., lb	160 mph	Max. wt., lb	170 mph	Max. wt., lb	180 mph	Max. wt., lb
RTSP-20-11G-12BC-136	20	0.120	6-3/8	12" sq. X 1"	12-3/4	1"X36"	25.0	625	25.0	625	25.0	625	23.5	588	21.9	548	19.3	483	16.1	403	13.3	333	11.7	293	10.1	253	8.9	223	7.5	188
RTSP-20-7G-12BC-136	20	0.188	6-3/8	12" sq. X 1"	12-3/4	1"X36"	25.0	625	25.0	625	25.0	625	25.0	625	25.0	625	25.0	625	25.0	625	22.1	553	19.1	478	16.7	418	14.7	368	12.7	318
RTSP-25-11G-12BC-136	25	0.120	7-1/8	12" sq. X 1"	12-3/4	1"X36"	25.0	625	25.0	625	22.3	558	17.5	438	15.3	383	13.9	348	11.3	283	9.1	228	7.9	198	6.5	163	5.5	138	5.1	128
RTSP-25-7G-12BC-136	25	0.188	7-1/8	12" sq. X 1"	12-3/4	1"X36"	25.0	625	25.0	625	25.0	625	25.0	625	25.0	625	24.3	608	20.1	503	16.9	423	14.5	363	12.5	313	10.9	273	9.5	238
RTSP-30-11G-12BC-136	30	0.120	7-3/4	12" sq. X 1"	12-3/4	1"X36"	25.0	625	25.0	625	20.3	508	15.7	393	13.9	348	12.1	303	9.9	248	7.9	198	6.9	173	5.9	148	4.7	118	4.3	108
RTSP-30-7G-12BC-136	30	0.188	7-3/4	12" sq. X 1"	12-3/4	1"X36"	25.0	625	25.0	625	25.0	625	25.0	625	25.0	625	23.3	583	18.9	473	15.9	398	13.9	348	11.7	293	10.1	253	9.1	228
RTSP-35-11G-12BC-136	35	0.120	8-3/8	12" sq. X 1"	12-3/4	1"X36"	25.0	625	23.1	578	16.9	423	12.7	318	11.1	278	9.9	248	8.1	203	6.5	163	5.1	128	4.5	113	3.7	93	3.1	78
RTSP-35-7G-12BC-136	35	0.188	8-3/8	12" sq. X 1"	12-3/4	1"X36"	25.0	625	25.0	625	25.0	625	20.9	523	18.9	473	16.7	418	13.9	348	11.3	283	9.5	238	8.1	203	7.1	178	6.1	153
RTSP-39-11G-12BC-136	39	0.120	9-1/8	12" sq. X 1"	12-3/4	1"X36"	25.0	625	23.1	578	16.9	423	12.7	318	11.1	278	9.9	248	8.1	203	6.5	163	5.1	128	4.5	113	3.7	93	3.1	78
RTSP-39-7G-12BC-136	39	0.188	9-1/8	12" sq. X 1"	12-3/4	1"X36"	25.0	625	25.0	625	24.5	613	19.1	478	16.7	418	14.9	373	11.9	298	9.9	248	8.5	213	6.9	173	6.1	153	4.9	123
RTSP-39-7G-15BC-136	39	0.188	9-1/8	15" sq. X 1"	15	1.25"X40"	25.0	625	25.0	625	25.0	625	23.9	598	21.3	533	19.1	478	15.5	388	13.3	333	10.9	273	9.3	233	7.9	198	6.7	168

*Pole Assemblies With EPA>9.0 Require Specific Review

CAUTION: Installation of poles without luminaire(s) will compromise pole strength. Any accessories attached to the pole, or other modifications done in the field, will compromise the pole strength and may result in pole failure. Wind load evaluations and provisions for appendages such as banner arms, signage, cameras, etc., must be evaluated and approved by the factory prior to placing an order. Additional evaluation and approval should be performed by the customer's local structural engineer on the project.

***Anchor Bolts are NOT included with Custom Bolt Circle.
*Do NOT pour concrete referencing this drawing. Consult Factory.
*Must Specify 4-Bolt Pattern.**

***All wind loading calculations are based on sustained wind force plus an additional 1.3 gust.**

MOUNTING CONFIGURATION



Single
(SGL)



Double
(D-90)



Double
(D-180)

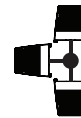

Triple
(T-90)

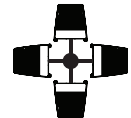

Quad
(QD)

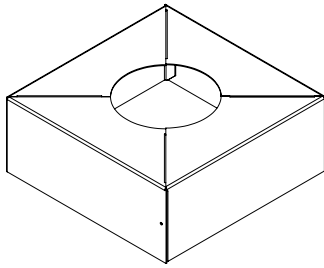

Base Cover

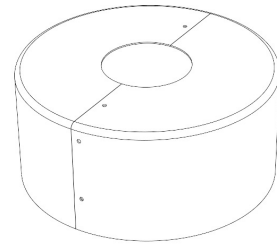

**Optional Round
Base Cover**

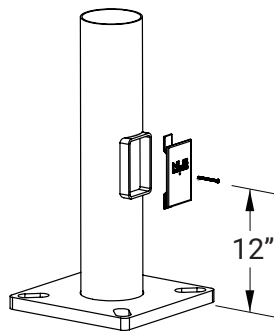

Base Detail

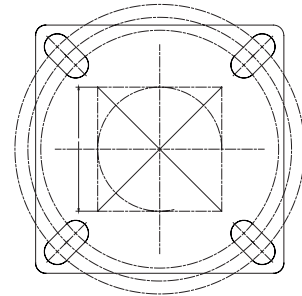

12" Base Detail

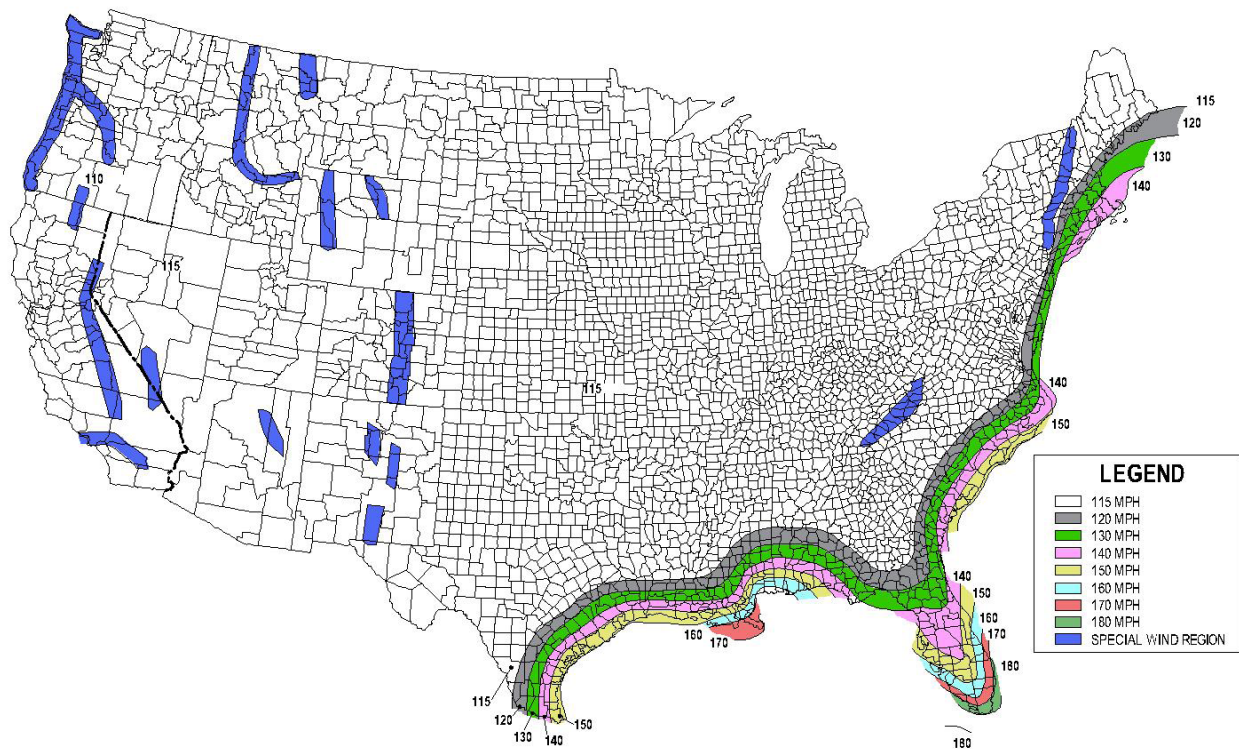

FIG. 3.8-1b - 700-Year MRI Basic Wind Speed, mph (AASHTO LRFDLTS-1)

- 1) All wind load calculations are based on sustained wind force plus and additional 1.3 gust
- 2) Wind Map is to be used as a reference only. Please coordinate with local agencies for further review.
- 3) Wind Map values are based on a 50 year mean recurrence. These values do not account for severe conditions, such as hurricanes, tornadoes, etc...
- 4) For review of poles with additional configurations (arms, banners, shorter/longer pole lengths, etc...), please contact factory.

BUY AMERICAN OPTION

While all of the NLS Lighting products listed in this document qualify for the Buy America(n) Act of 1933, we reserve the right to change our listings without notice.

The information provided above is for general informational purposes only. We encourage you to consult legal professionals for advice particular to your projects concerning BAA, TAA, BABA or Buy America.

Additional NLS Products that meet BAA, TAA standards can be found at the following link:

[https://nslighting.com/wp-content/uploads/cs/NLS_BuyAmerica\(n\).pdf](https://nslighting.com/wp-content/uploads/cs/NLS_BuyAmerica(n).pdf)